

MISC. PROJECTS

- (1) 05-03 (03) NEWTON RD CHIP ARCH
- (2) COUNTY SHOP FENCE. DEC 77-9 JAN 78
- (3) COUNTY SHOP BUILDING & GAS TANKS
MAR 78
- (4) COUNTY STORAGE SHED STAKING
JULY 79

COUNTY SHOP BUILDING

INDEX PAGE

JOB NO.	PROJECT	PAGE NUMBER
	OS-03(03) ^{CHP ARCH} NEWTON RD AND DIARY	2
COUNTY SHOP	Fence Contract	14
COUNTY SHOP	BUILDING CONTRACT	19
	FOOTING ELEV.	21

①

05 03(03)

LABEL FROM 83x57x70' CWP

Wheeling Pittsburg

Copper steel 2oz coating

AASHO M218

ASTM A-444

.079 HT 170972

LOT 73 F 987

A Hudson

WHEELING PITTSBURG

COPPER STEEL 2 OZ COATING

AASHO M218

ASTM A-444

.079 HT 170972

LOT 73 F 987

A Hudson

①

25 OCT 77

HUDSON - P.C. NOTES

WARD - T

LEVELS TO B.M. BY BRIDGE

RAILROAD SPIKE IN POLE 1 POLE FROM
PC OF CURVE SOUTH OF BRIDGE.

PT	BS	HI	FS	ELEV	
	4.65	4420.01		4415.36	ODBM NWT-BENSON
TP U)	4.48	4418.21	6.28	4413.73	
	5.04	4417.87			
SPIKE IN POLE BY BRIDGE			5.38	4412.83	
ROAD ON BRIDGE			4.17	4413.70	
TOP OF BOLT ON WEST SIDE HEADGATE			9.57	4408.30	
WATER LEVEL 8 NOV 77				4407.35	
FL =		-2' =		4404.3	

2

ROAD TAKEN FROM P 153 BENSON BRIDGE
CACHE COUNTY BRIDGE IMPROVEMENT

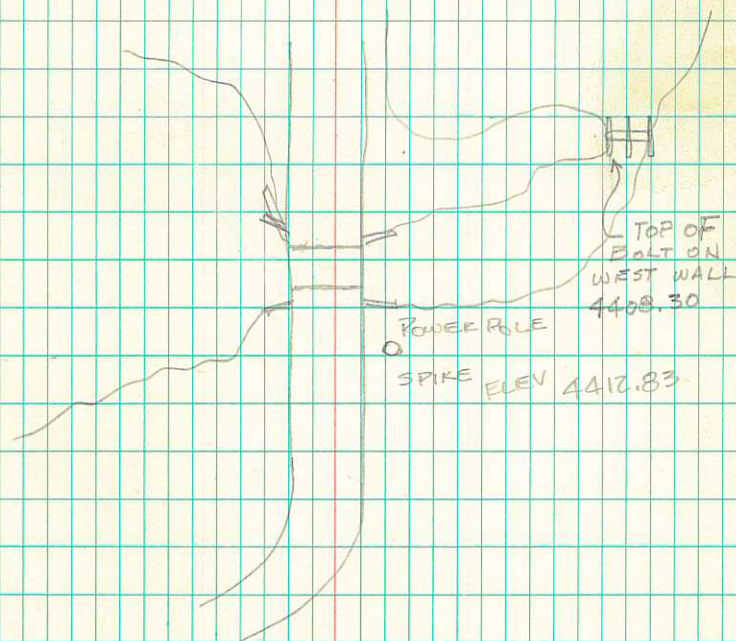

8 NOV 77

BACKHOE 9 AM REMOVED 2' FILL FROM DECK FINISHED 10 AM

3 10 WHEELERS 945 -

BROUGHT UP PIPE 1 1/2

AND ONE BROUGHT IN ~~1 1/2~~ TON BALL

LOADER 966 CAT 10:30

TO UNLOAD PIPE, UNLOADED AT 11:00

CRANE ARRIVED 11:00 AND STARTED AT 11:30 WITH 1 1/2 TON BALL.

SO FAR 1 BACKHOE 10-

1 FLAT RACK 10:30-

3 10 WHEELER 12 YD TRUCKS 10-

PATROL 9-

CRANE 11- 8 Loads gravel

PEOPLE TED ~~BY~~ BACKHOE

- PATROL

- FLAT RACK DRIVER

- 3 TRUCK DRIVERS

4 MEN 1 1/2 HR TO BEFORE UNCH TO PUT PIPE TOGETHER

2-3 MEN 2 HRS AFTER

3 MEN THERE ALL DAY.

8 NOV 77 FIRST DAY ON JOB

4

BACKHOE AND PATROL ARRIVED 9:55 AND KNOCKED THE 2' FILL OFF DECK. PIPE ARRIVED BETWEEN 9:45-10:20 ON TWO 12 YD DUMP TRUCKS AND FLAT RACK. 1 TRUCK WENT DOWN TO NIBLEY AND GOT 3000 * HEADACHE BALL. LOADER FROM COUNTY ARRIVED 10:30 AND UNLOADED PIPE AND SET SECTIONS TOGETHER ON WEST SIDE OF ROAD.

CRANE (599) ^{AMERICAN} ARRIVED 11:00 AM AND SET UP TILL 11:30 BALL HIT THE DECK AT 11:30. STOPPED AT 12:05-12:25 FOR LUNCH AND HAD BRIDGE DOWN BY 3:00 PM PULLED SECTIONS OUT TILL 4:00 PM SHUT DOWN AT 4 PM

BROUGHT IN 9 LOADS GRAVEL FILL FOR FROM TRENTON PIT.

2 TRUCKS HAULING LOADS

2 TRUCKS SITTING WHILE DRIVERS PUT PIPE TOGETHER. BACKHOE SAT FROM 10:00 AM. 3 MEN THERE ALL DAY - FROM 10:00 - 4:00. TED THERE

H 9-4 -

READY TO ATTACH CURB AND DIG OUT CONCRETE

IN CENTER OF CANAL.

LAY THE PIPE AND BACKFILL TOMORROW.

9 Nov 77

MEL - 8:20 - AND TED,

PATROL

FIRST TRUCKS 8:55

1 8:57

1 8:58

1 9:10

1 10:03

1 10:20

1 10:37

4 11:15

2 11:30

1 11:32

2 11:45

2 11:55

2 1:00

1 1:15

1 1:20

1 1:25

1 1:30

2 1:45

1 1:40

3 1:55

3 2:30

3 3:20

4 4:00

1/39

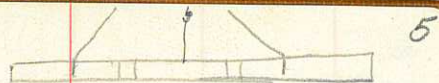

ARRIVED 8:40 MEL HERE. ALONG WITH
3 CRANE PEOPLE TRYING TO GET CRANE STARTED
CRANE STARTED AT 9:40 BACKHOE
STILL WONT START 9:40 - 10:20 RIGGING
CLAM, CLAM IN THE WATER AT 10:20
OUT OF WATER READY FOR PIPE AT 11:30
TOOK OFF CLAM, PUT ON HOOK AT 11:55
PIPE SET AT 12:20 LUNCH TILL 12:40
UNHOOK FROM PIPE AT 1:00 - ATTACH
^{CLAM}
DRAGLINE TILL 1:35 FIRST LOAD ON PIPE
AT 1:35. AT 2:30 2 LOADS ON SOUTH
SIDE CRANE STOP AT 2:30. REST
WITH BACKHOE. CRANE LEFT AT 3:20.
GRADER ACROSS AT 3:10. BLADED FILL
OUT TO 12' WIDE. FINISHED AT 4:00

10 NOV 77

MED & TED HERE 8:15

LOADS 3x2 8:47

3 9:15

4 10:00

3 10:40

4 11:00

~~64 LOADS = 768 CUYD~~

ALL DAY 70 LOADS = 840 CUYDS

6.

ARRIVE 8:30 PATROL BLADE NORTH SIDE
ROAD. BACKHOE KNOCKED STEEL OVER TO
BE BURIED. LOADS ARRIVED 8:50. BACKHOE
WILL START SETTING FILL ON ENDS OF
PIPE. BACKHOE SET BUCKET ON END OF
PIPE (WITH CUSHION OF FILL) AND DUMPED
FILL ON PIPE TO SET ENDS DOWN TO
GRADE. PIPE ON GRADE AT 10:00. PATROL
STARTING TO WIDEN AND FILL. BACKHOE
~~LEFT AT 10:15~~. TOOK DOWN ROAD CLOSED
SIGNS AT 10:30.

11 NOV 77

PATROL & OPERATOR

NORTH LOGAN 4 LOADS 9 AM ON CULVERT
4 LOADS 10 AM ON CULVERT
4 LOADS 11 AM ON APPROACHES

7

ARRIVED 8:30. BROUGHT IN 4 LOADS OF
CRUSHED FROM NORTH LOGAN PIT
FOR EACH SIDE OF ROAD. CUT 14-16
INCHES OF BORROW ~~OUT~~ OUT AND PLACED
CRUSHED GRAVEL IN.

TESCO

4' 7'

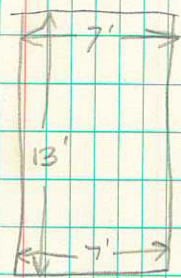

- 13' ON 71 FORD
- 15' ON 77
- 14' ON 75 FORD
- 14' ON INTER.

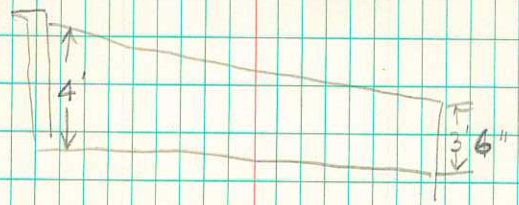

HILL

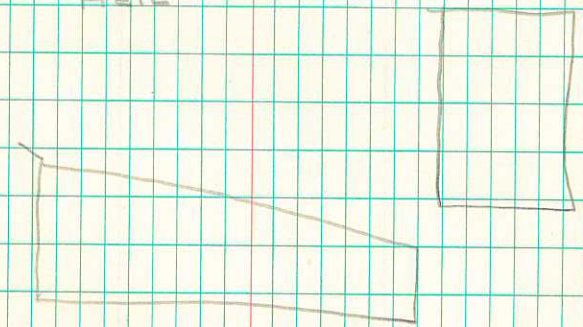

COUNTY SHOP FENCE JOB

CONTRACTOR: MOUNTAIN STATES FENCE SLC

CONTRACT DATE 30 NOV 77

START - 19 DEC 77, COLD WINDY

14

3 MAN CREW ARRIVED AT 10:40 AM. UNLOADED
TRACTOR AND RAN EAST LINE WITH STRING
AND TAPE. DUG 6 HOLES THEN JAMMED
AND TOOK 1 HR TO FREE MACHINE.

11:19 STARTED AGAIN. DUG MOST OF EAST LINE
LEFT AT 4:20 PM

Q. Hudson

20 DEC 78

CREW STARTED LATE. BROUGHT UP
150 2" LINE POSTS 9' LONG INSTEAD
OF 9'8" SO TOOK THEM BACK. DUG 15
HOLES LEFT AT 2:00 PM

A. Hudson

Intermittent snow + rain

Dec 28, 1977

Tractor operator arrived about 11:00 AM
Flat bed truck arrived about 11:00 AM
with two bundles of iron posts.

I measured them to be 9' 8" by 2"
outside diam. Dug most of holes
on south boundary.

Discussed with Foreman:

pull posts to be placed at minimum
of 500' therefore one on north
and south boundary at 300'.

G. Richardson

Intermittent snow + rain

16

Dec 29, 1977

Finished digging holes.

Started pouring concrete about 2:00 PM
from Johnson's; 28 cu. yd.

Temperature about 35°. Poured east end
 $\frac{1}{2}$ of ~~posts~~ south side posts

5 men

2 flatbeds

1 pickup truck

CLOUDY, WARM

5 Jan 78

PLACED BARBED WIRE ARMS AND TOP
RAIL AND POURED CONCRETE IN LAST 4
LINE POSTS ON NORTH EAST CORNER.
WILL PUT FABRIC ON TOMORROW. GOT THERE
AT NOON - LEFT ABOUT 4:30. 3 MEN
I WENT OUT AT 3 PM.

Atkinson

COOL CLOUDY, RAINY ¹⁷

6 JAN 78

3 MAN CREW ARRIVED ABOUT 11. AND
STARTED PUTTING UP FABRIC. ~~BY~~ BY 1:15
THEY HAD INSTALLED EAST AND EAST HALF
OF NORTH LINE. INSTALLED ALSO WEST LINE

Atkinson

7 Jan 78

3 MAN CREW PUT UP N FENCE AND
TIED FENCE AND PUT UP GATES.
FENCE FINISHED PM 7 JAN 78

Abdulron

18

Jan Mar 29, 1978
Met Bob Trencher, his brother,
Yancy, and Zucher on site.
Located site for tanks. Said
County would furnish feed for
Smoking Tanks. Sethi to set it
up.

1, 6000 + 1, 2000 tank arrived
in PM. Badly scraped in hand-
ling. Will have to be painted.

GJK

April 3, 1978

6000 + 1000 gal tanks arrived.
We restaked location.

GJK

April 4, 1978

Back hoe + operator dug hole.
Sethi's gang hauled top soil away
and gravel in. Placed tanks
and back filled $\frac{3}{4}$ way up.

1 rented back hoe + operator

1 " Crane + 2 oper

1 - 1 yd backhoe + scraper

1 - 2 yd "

A laborer + boss working
gas + methyl placed in tanks.

GJK

Fair April 5, 1978

Rain during night. Some Ref. Steel etc
Delivered to Job. 2 supervisors back files
and misc. work.

Checked plumbing list, job ok.

GJK

Continue back filling tanks. April 6, 1978
Placed plumbing for air vents and filters

GJK

Rain during night April 7, 1978

Back hoe on job. Staking out building.
Reminded Bob + Steve that concrete would
require a vibrator and cure for 7 days.

Big back hoe + oper

1 stake driver

Little back hoe + operator

Basso on tamper and setting grade

GJK

Cont. on page 22

3 APR 78

SITOP BUILDING CORNERS

HUDSON NOTES

WARD T

RICHARDSON ϕ

GRADE

+4.0

HI

-

ELEV

BM

8 ~~39~~

4458.22

4449.82

GRADE EL

4453.6

GRADE ROD

4.62

ELEV. OF FOOTINGS 21
COUNTY SHOP

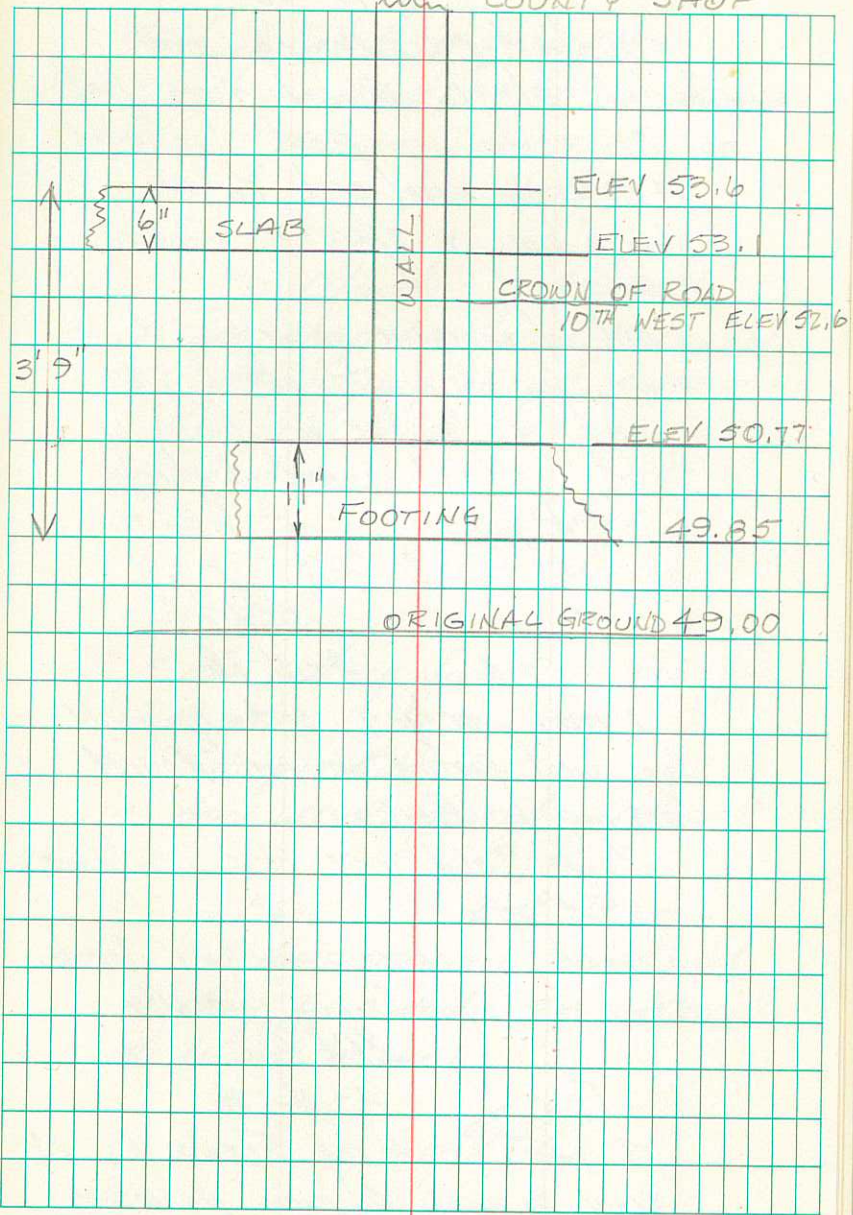

Fair

4-10-78

Finished excavating and started steel. Placed two loads of concrete in East footings.

4 men on steel and concrete.

Bob, k huc + operator + helper
3 bosses

1 load of concrete in broken down mixer, finally unloaded, for 1 load for extra 2 yds.

Total 3 loads and 2 yds for 1/2 footing on south & East worked till 7:30

GJR

Fair

4-11-78

1 man working setting forms for west footing in AM. Poured footing in P.M.

Bob told me the building was 4' short.

2 kind using saw for joints. Expansion joints at walls

GJR

Fair

4-12-78

3 men setting forms for N and S walls. 3 men pouring

22

Starting about 2:50 PM
2 men from butter setting under
bats. Finish about 7:30

GJR

Cloudy

4-13-78

6 men stripping forms, worked all day trying to get cure on under. Had to go to edge to get parts process.

GJR

Rain

4-14-78

5 men setting forms in PM from 1:30 on.

Sunny in P.M.

Same crew poured west wall

GJR

Fair

4-15-78

5 men stripping forms and resetting East wall. Told foreman to get cure on wall.

GJR

Snow Showers, 4-17-78
Called Steve Tschler and told
him it was too cold to pour
today.

A man working on forms
This will be a non working day
because of cold weather, 25° by
weather report.
GJK

Fair 25° ~~last~~ 4-18-78
with

Concrete arrived at 9:00 to
pour East wall. 6 men pouring
and setting anchor bolts. Finished
at noon
GJK

Fair 4-19-78
 27° Last Night.
Striped forms. 4 men
working.

G. L. Richardson
Fair 4-20-78
3 Footings back filling.
G. L. Richardson

Snow Showers 4-21-78
I was placing insulation
around foundation
GJK

Cloudy 4-24-78
poured floor of center drain
and set gas island to grid.
GJK

Cloudy 4-25-78
digging hole for sand trap
stripped forms for drain.
GJK

Showers 4-26-78
Rain during night. Striped grade
for floor.
Poured bottom of sand trap at noon
G. L. Richardson

Showers 4-27-78
Graded and rolled floor.
Poured footings for interior wall.
G. L. Richardson

Cloudy 4-29-78
poured interior walls.
working on plumbing for drain

G.F. / Rubada

Fair 4-30-78
putting in copper tubing
for water lines - Backfilled
50' of sand to drain.

G.F. / Rubada

Fair May 1, 1978
Placing water lines and
forming floor for NW 1/2 of
Garage. Picked county water
Truck for water supply.

G.F. / Rubada

Fair May 2, 1978
Decided not to pour floor.
2 Electricians working + plumber
Set screed in RM. Grade an inch
high. Had to pick up wire
to fix it.

G.F. / Rubada

24

Fair-windy May 3 1978
poured N.W. slab in AM.
to men screed machine, flats,
plumber working on office
partition.
set screeds for NE partition.

G.F. / Rubada

Cloudy May 4 - 1978
2nd cut curbs on NW porch
poured NE partition in PM
1 plumber working
2 electricians

Grass pit delivered at 3:00 PM.
G.F. / Rubada

Cloudy May 5, 1978
Decided to allow use of
plastic pipe for conduit
below concrete because of
conflicting instructions. Grass
pit too large.

2 Electricians working
1 plumber
Backhoe dug pit for crane
and pit.

G.F.R

Showers May 6 1978

3 men getting spreads
placed grease pit in
hole. I told them to
compare for offset
length.
G.F. Richardson

Fair May 7, 1978
Poured shop area floor
except for grease pit area.

5 men crew
plumber working on office
area. Ok'd another estimate.
G.F. Richardson

FAIR MAY 9 1978

POURED APRON ON WEST ^{SIDE} ~~END~~ OF
BUILDING ALONG GARAGE AREA. PREPARED
BALANCE OF WEST APRON. ELECTRICIAN
WIRED PUMPS - WIRED EACH SEPERATELY
IN 1/2" CONDUIT AND NOT ALL IN ONE
2" CONDUIT. SET 2" CONDUIT OUT

CONT.

MAY 9 1978

14' FROM BUILDING 1' SOUTH OF SOUTH
BUILDING WALL. RAN AN ADDITIONAL 1 1/4"
CONDUIT OUT BEYOND PUMP ISLAND FOR
100' SERVICE TO SERVICE STATION.
PLUMBER RAN WATER TEST ON PLUMBING
AND LOGAN CITY INSPECTED IT.
STARTED TO BACK FILL. 3 MAN CONCRETE
CREW, 1 MAN PLUMBER. CONCRETE ON APRON
FINISHED WITH BROOM. Q. Hudson
WARM, SHOWERS, MAY 10 1978

POURED SOUTH END OF WEST APRON
IN A.M. PREPARING STEAM CLEANING
PAD. PLUMBER BACKFILLING AND HAD
2 HELPERS. 3 MAN CONCRETE CREW.
POURED STEAM CLEANING PAD.

WARM RAIN SHOWERS, MAY 11 1978

POURED EAST APRON, ~~ON~~ NORTH
HALF TIED ^{AND WELDED} STEEL TO CRANE BOLTS
AND SET FULL DEPTH INTO HOLE.

POURED CRANE FOOTING, COMPACTED
OFFICE FLOOR.

A. Hudson

12 MAY 78 WARM DRY

POURED OFFICE SLAB AND CLEANED
UP. 3 MAN CONC. CREW. CITY
DUG POWER ACROSS 10TH WEST TO
PROPERTY LINE.

A Hudson

Fair - 5-22-78

Erected two columns.

G. L. Richardson

Fair 5-22-78

Erected 4 columns

G. L. Richardson

Fair Windy 5-24-78

Finished columns on ~~the~~ garage
section. Agreed with plumber to put
drain on inside of pit.

Fair 5-25-78

Erecting purlins + ties
plumber on grease pit.

Oked changing discharge
line to inside of pit.

G. L. Richardson

Fair - 5-26-78

Continued on beams +
purlins.

G. L. Richardson

Showers 5-27-28-29-78
+ wind.

Dug and placed waste tank.

G. L. Richardson

Fair Windy 5-30-78

Working on purlins.

Waste tank flooded. I told
them they could fill with
water.

G. L. Richardson

5-31-78

Fair + cold.

Erecting curbers over shop
Area.

G L Richardson

Fair

6-1-78

Erecting curbers on ends.
Plumber on gas tanks.

G L Richardson

Cloudy

6-2-78

Erecting End sections

G L Richardson

Fair

6-5-78

Reset oil tank and
connected plumbing. Set me
door frames on building and
purifiers, + end pieces.
Tid stove pt. to make w/d
flush with steel.
Checked in insulation

26

which was delivered. 3"
on walls and 4" on roof.
Tid job also checked doors - all
to be 4' high.

G L Richardson

Fair.

6-6-78

Back filled tank at shop
2 men and back hoe.

Placing metal on end wall
4 men.

G L Richardson

Fair -

6-7-78

Installed air line to
Island + back filled

Plumber -

4 men erecting metal.

G L Richardson

Fair

6-8-78

5 men - Poured concrete for
Island + pit

4 men erecting metal, w. wall.

G L Richardson

Fair - 6-9-78
4 men poured concrete pit
and floor.

4 men working on metal
walls. Talked to Steve Thatcher
about growing strips that do
not rest on concrete. He will
do it.

G. F. Richardson

Fair 6-12-78

4 men erecting wall
shedding.

G. F. Richardson

Hot 6-13-78
Poured interior wall around
Grass pit. 2 men
erecting wall shedding 4 men

G. F. Richardson

Hot 6-14-78
4 men placing wall starters
on South wall.

G. F. Richardson

Hot 6-15-78
4 men Erecting wall shedding.
G. F. Richardson

Warm 6-16-78
4 men Erecting shedding on East
wall.

Bob Thatcher digging sewer connection
with backhoe. Plumber working
on sewer connection.
With Thatcher discussed.

1. Building plans need approving
by Engineer
2. Place crane before roof
3. Need 600 for Galvanizing.

G. F. Richardson

Hot 6-19-78
Start covering roof.
write letter to Thatcher on galvanizing.

G. F. Richardson

Hot 6-20-78
4 men placing roof panels.
G.F. Richardson

Hot 6-21-78
Connected sewer line to
City.
4 men on roof.
Laying out for framing.
G.F. Richardson

Hot 6-22-78
4 men on roof.
4 men framing.

Hot 6-23-78
7 men on roof.
4 men framing.
Bob Fletcher brought over
3 ccs for roof, Elaine's policy,
and shop doors.
G.F. Richardson

Hot 6-26-78
3 boys framing and
bracing.
4 men framing.
1 + old Steve ok. to
use plywood for porch
board.
G.F. Richardson

Hot 6-27-78
4 men erecting gutters and
installing braces.
4 Carpenters on framing.
talked with Bob and Steve
about fire well, and framing
around beams. Will have to pay
extra for hand rail.
G.F. Richardson

Hot 6-28-78
2 men on braces + gutter
4 " framing 2nd floor.
GFR

Hot. 6-29-78

2 Men cutting in windows
4 Men carpentering.

Agreed to pay Bill for hand
rail on step.

Also to use 2x8 instead of
2x6 for Loft ceiling to
provide storage area.

G.L. Richardson

Hot 6-30-78

3 men cutting in windows

4 " framing in rooms.

wash room cracked. G.L. Richardson

warm 7-3-78

No work.

7-4-78

No work.

Hot 7-5-78

2 Electricians - I reviewed plans
and location with them.

4 Carpenters erecting center wall.

2 metal workers gutters + cross rails.

G.L. Richardson

29

Hot 7-6-78

Discussed ~~the~~ steps with Leo.
wanted extra for framing. talked
with John + Grant and decided
it was in the specs.

2 electricians

4 framing

1 plumber.

G.L. Richardson

Hot 7-7-78

4 framing

2 electricians

1 plumber

metal workers about through
except for missing panel.

Delivering doors.

G.L. Richardson

Hot 7-10-78

4 carpenters finishing shop wall

3 workers erecting doors.

G.L. Richardson

m

Hot 7-11-78
3 workers on folding doors.

G.L. Richardson

Hot 7-12-78
3 workers on doors
Boys were anxious about
checks

G.L. Richardson

Hot 7-13-78
4 erecting last part
of metal building.
Discussed plans with
Electrician.

Hot - 7-14-78
3 men finishing up metal.
2 electricians

G.L. Richardson

30
Hot 7-17-78
4 men on doors
2 electricians

G.L. Richardson

Hot 7-18-78
2 men erected a little plaster
board on middle wall.

G.L. Richardson

Hot 7-19-78
Electrician working on
wiring. Plumber in evening.

G.L. Richardson

Hot 7-20-78
2 Electricians working.

G.L. Richardson

Hot 7-21-78
1 man on plumbing
2 electricians on garage portion.

G.L. Richardson

Hot 7-25-78

2 Electricians working
wall board on job.

G. L. Richardson

Hot 7-26-78

4 men on Heating and
Plumbing. Got water tank for Plumber

G. L. Richardson

Hot 7-27-78

Delivered Crane
Erected one door in shop
Installed wash fountain

G. L. Richardson

Hot 7-28-78

2 men on doors
2 heating + plumbing

G. L. Richardson

Hot 7-31-78

2 men on doors
2 men on plumbing
They asked me about lead
flashing for roof vents. I said ok.

G. L. Richardson

Hot 8-1-78

2 men on Electric
2 men on Insulation

G. L. Richardson

Hot 8-2-78

2 men on insulation
1 electrician

Discussed with B. Thatcher
Telephone. Told them inside conduit
was theirs. The rest ours.

G. L. Richardson

Hot 8-3-78

2 men insulation
2 Electrical.

G. L. Richardson

Hot 8-4-78

- 2 Cleaning up Insulators
- 2 Electricians working

G. F. Richardson

Placed wall board over
North Shop wall over weekend

Hot 8-7-78

- 2 Electricians
 - 2 Insulation + wall board
 - 2 Carpenters in finish
- City delivering water pipe
along road

G. F. Richardson

Hot 8-8-78

- 2 Electrician
- 2 Carpenters on windows
- 2 placing wall board

G. F. Richardson

Hot 8-9-78

- 2 Carpenters finishing
 - 2 wall board
 - 1 plumber
 - 2 installing heaters
- Discussed Wainscotng. Told Bob to
present claim at end of Carpenter Contract
- G. F. Richardson

Hot 8-10-78

- 2 Electricians
- 2 wall board
- 2 carpenters on wainscotng

G. F. Richardson

Vacations - 11 to 18 inclusive

Fair

8-21-78

Electricians working - door frames
etc. being delivered.

G. F. Richardson

Fair 8-22-78

2 electricians working.
Talked to Bob about heaters.
He said they would work.
G. F. Richardson

Fair 8-23-78

2 men blowing in insulation,
2 electricians working.
They are being held up because
of pay board isn't in.

G. F. Richardson

Hot 8-24-78

2 Electricians
John says Cabana in wrong
place. I left word for
Steve Thatcher G. F. Richardson

Hot

8-25-78

Talked to Steve about adjust mats
and good compensation. Said we
should be about even. Said up to
using 1" cable to provide for future
connectors to electric box

4 plumbers

4 carpenters setting doors

2 plumbers on ventilators

1 man hose work on gas
pumps

G. F. Richardson

Warm 8-28-78

2 electricians

2 Plumbers on duct work

2003 backhoe on trim and
clean up.

Crane upright on road over
weekend

G. F. Richardson

Warm 8-29-78

2 electricians
2 plumbers
2 boilers getting ready for start
talked to Steve about finishing
items.

G. F. Richardson

Warm 8-30-78

3 electricians
talked to Steve about window
map circuit. Selected circuit
OK check for aspect to
Lindisfarne.

~~Agree~~ Thatchers erecting crane
G. F. Richardson

Warm 8-31-78

1 Painter filling holes
3 Electricians - finishing up.

G. F. Richardson

Warm 9-1-78

1 Electrician
1 Painter on doors

G. F. Richardson

Warm 9-5-78

Crane installed over the weekend.
1 painter on 1st coat.
2 electricians
1 plumber.
changed orders for crane clearance.
sent letter to Thatchers on time
assessment.
sent check list of things to do
to finish.

G. F. Richardson

Warm 9-6-78

Painter,
Electricians working
City installing water meter
Electricians said 1st day
hold up by box not put
there.

G. F. Richardson

Scattered Showers 9-7-78
Gutters leaked at all joints

2 Electricians

2 Painters

Mail box arrived and was
installed.

Painted shop wall

G. F. Richardson

warm 9-8-78

2 electrician

2 cleaning up

2 Plumbing effort on

2 placing tile board.

G. F. Richardson

2 electricians 9-11-78

2 placing drains tile

1 work bench

Showers 9-12-78

Two Tile

2 electricians

Electrical sub called and took
look up. I told him to build it.

G. F. Richardson

cloudy 9-13-78

2 Electricians

2 tile layers

1 Plumber

City installing electricity
Telephone cable in.

Oked putting base on tile
Reviewed ~~our~~ building
with Alex.

Electricity turned on.
G. F. Richardson

Sept 14 + 15
I was in Richfield
and did not see the job.

G. L. Richardson

Snow in the Sept 18 1978
night. Looks on roof.
Went over entire deal with Sath.
Gave Contractor final list.
Plumber on exhaust pipes
2 men on fixtures etc.
Carpet has been laid.

G. L. Richardson

Showers Sept 19 1978
Told painter about
storage room.
one workman on fixtures
etc.

G. L. Richardson

Fair Sept 20 1978

one man on counter tops.

G. L. Richardson

Fair Sept 21 1978
No one on building in
AM. I was gone most of
day.

G. L. R.

Fair Sept 22 1978
plumber on skids
and stuff.
2 on duct system
in P.M.

G. L. R.

Fair Sept 25 1978
Reviewed list with Steve.
2 men on duct system
2 men on clean up in AM
Bob called on chalking

G. L. Richardson

Fair 9-26-78

one man on doors,
finishing cabinets etc.

G.L. Richardson

Fair 9-27-78

1 man cleaning up
1 man on roof.

Long talk with Electric plumber
and Bob Star on hook up of
gas pumps. Told them that
Specs. required a hook up.
They will see Long Wayne.
Went over list again.

G.L. Richardson

Fair 9-28-78

one man working on roof
one man cleaning up

G.L. Richardson

Fair 9-29-78

one man cut holes for vents
in roof.
2 men wiring gas pumps

G.L. Richardson

Fair 10-2-78

No work.

G.L. Richardson

Fair 10-3-78

No work.
Delivered letter to Irving.

G.L. Richardson

Fair 10-4-78

Several people bring odd
jobs. & odd things

G.L. Richardson

Fair, 10-5-78
Went over list with Steve
and again with Bob.

Plumber finish exhaust,
Adjust headers. Placing
stud frame window.

Agreed to accept building
today provided other items
of finish were completed in
30 days.

Boys working on door framing

Bill Richardson.

500
53 29

22 SEPT SUBBASE STAKING - SHOP

50' INSIDE PAD ELEV = 4553.6 4⁹⁰

OUTSIDE PAD ELEV = 53.4 - 5¹⁶

INSIDE 4⁹⁰ 483.6

OUTSIDE 5⁰² 4553.85

SUBGRADE 5³³

+ 60 6⁰⁵

NORTH END

OUTSIDE ADON 5⁰⁴

GAS SLAB 4⁹⁰

NORTH SUR 5⁰³

+25' 5⁰⁶

+50 5²¹

+75 5⁴²

+125 5⁹³

GAS SLAB

NW CORNER 4⁹⁰

NORTH SUB 5⁰¹

+25 5²⁵

+50 5⁴³

+75 5⁶²

+100 5⁹³

WEST 25 6⁰³

5³⁷

5⁰⁶

5¹⁰

+ HI - ELEV

BM ELEV 4553.60

SET up 1 4.76 4558.36

ELEV A	5	65	4552.71	
ELEV B	5	94	4552.42	
ELEV C	6	37	4551.99	
ELEV D	6	57	4551.79	
ELEV ①	10	44	FL 4547.23	WATER
ELEV ②	11	65	FL 4546.71	WATER
ELEV ③	13	02	FL 4545.34	WATER

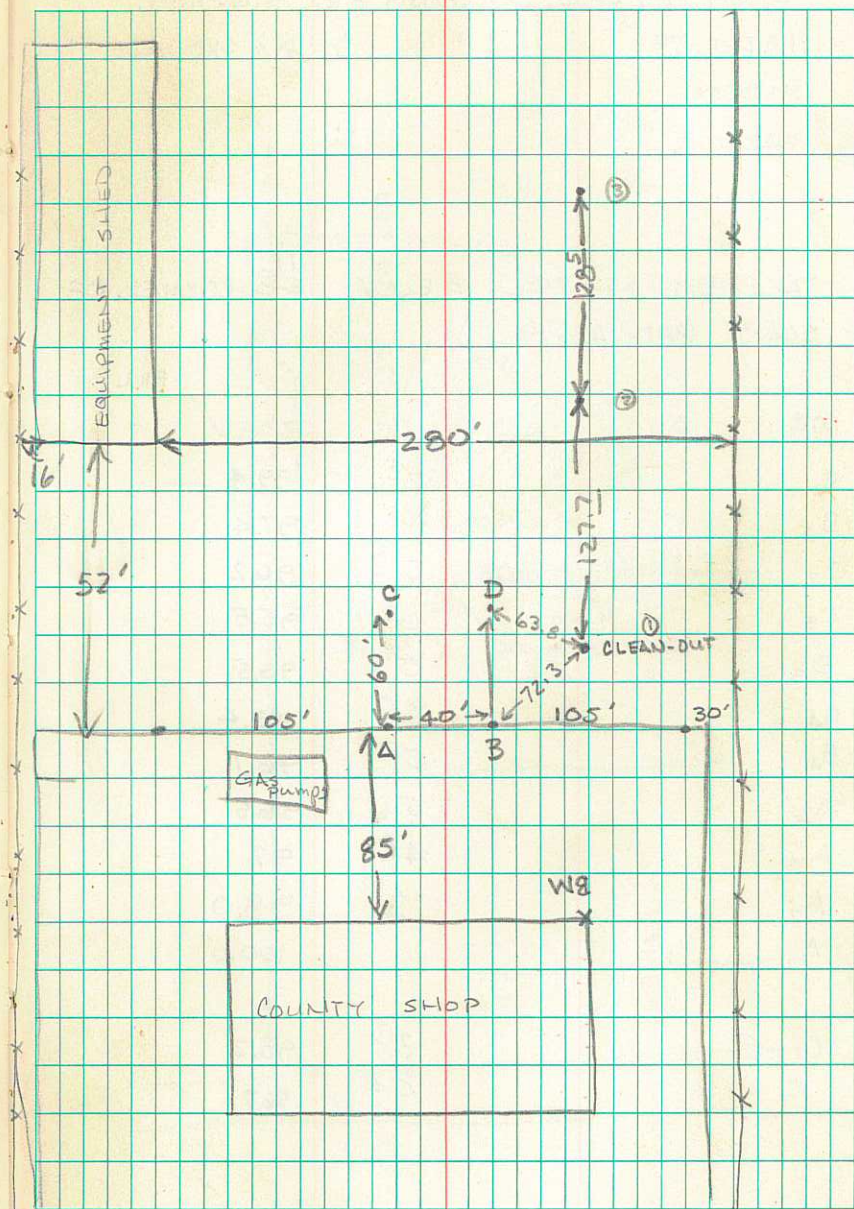

SHOP STORAGE BUILDING FILL STAKING.

11 APRIL 79

COLD & SNOWING

HUDSON

WARD R

TAKE BM ASSUMED A ELEV
SLAB/ PAD. (ASPHALT)

NE
SE CORNER OF

FILL

STA	BS	HI	FS	ELEV
B ₁			2 ⁵	99.4
B ₂			4 ⁵	97.4
C ₂			5 ²	96.2
C ₃			6 ⁴	95.5
B ₃			5 ⁴	96.5
C ₄			6 ⁵	95.4
B ₄			5 ⁸	96.1
A ₄			5 ⁴	96.5
A ₃			4 ⁸	97.1
A ₂			3 ⁹	98.0
A ₁	1 ²			100.0
C ₁₊₅			3 ²	98.2
C ₁			5 ²	96.7

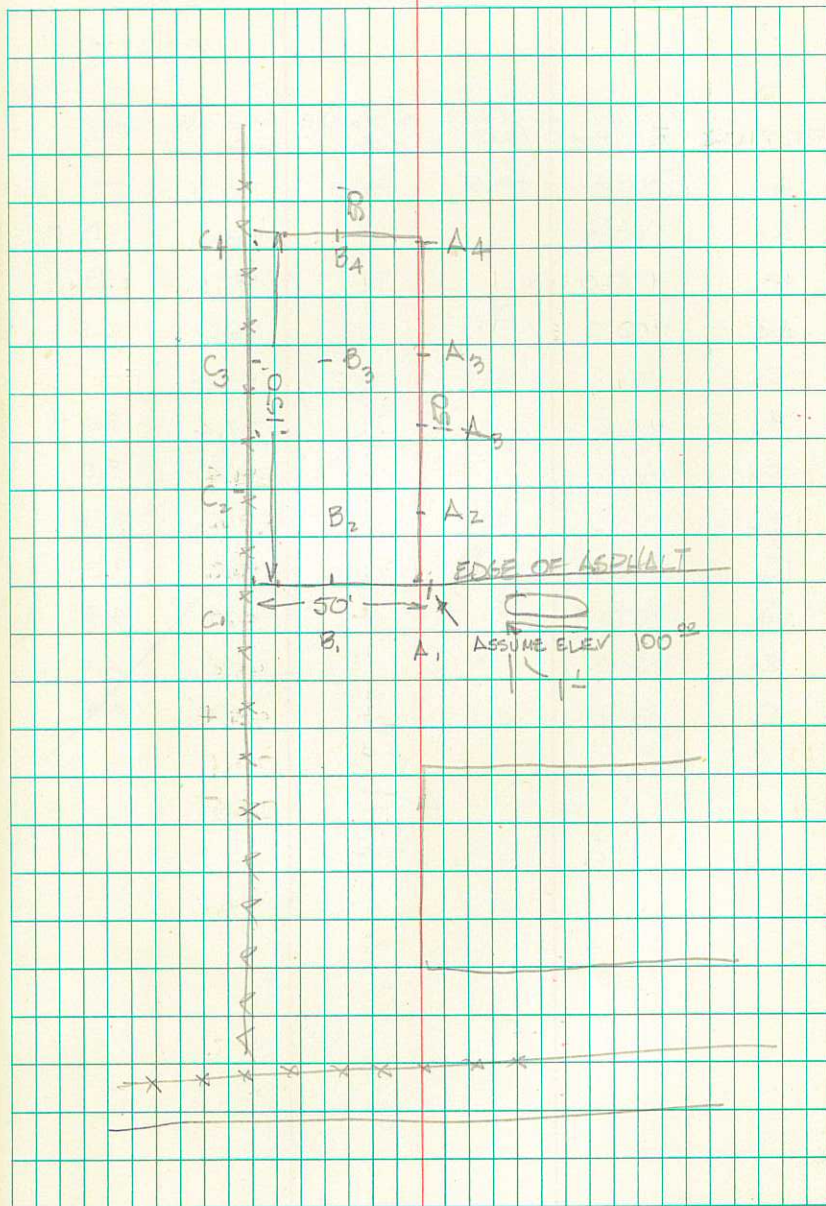

STATION	FINISH GRADE	SUBBASE ELEV	SUBGRADE ELEV	EXISTING ELEV	FILL
A ₁	100.0	99.5	99.0	100.0	—
A ₂	100.0	↓	↓	98.0	1.0 F
A ₃	100.0	↓	↓	97.1	1.9
A ₄	100.0	↓	↓	96.5	2.5
B ₁	100.5	100.0	99.5	99.4	—
B ₂	100.5	↓	↓	97.4	2.1
B ₃	100.5	↓	↓	96.5	3.0
B ₄	100.5	↓	↓	96.1	3.4
C ₁	101.0	100.5	100.0	96.7	3.3
C ₂	101.0	↓	↓	96.2	3.8
C ₃	101.0	↓	↓	95.5	4.5
C ₄	101.0	↓	↓	95.4	4.6

VOID

FINISH GRADE

BM	1.9	101.9	100.0	
A+36		4.1	97.8	97.0
A+18		4.9	97.0	97.4
A+0		5.6	96.3	97.2
FENCE				
A+50		3.9	98.0	96.8

B+36		5.3	96.6	97.0
+18		5.9	96.0	97.4
+0		6.3	95.6	97.2
B+50		4.8	97.1	96.8

C+36		5.8	96.1	97.0
C+18		6.4	95.5	97.1
C+0	FENCE	6.5	95.4	97.2
C+50		5.4	96.5	96.8

D+36		6.4	95.5	97.0
D+18		6.8	95.1	97.1
D+0		7.2	94.7	97.2
		6.1	95.8	96.8

C TO FINISH FLOOR
 CUT/FILL TO SUB BASE
 6" CONG SLAB
 6" BASE
 $SUBBASE = FINISH - 10$

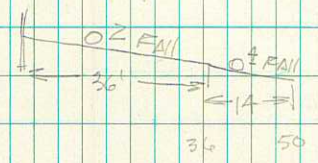

C1⁸ C1⁸
 F0¹ C0^{8A}
 F1¹⁰ F0¹¹ GRADE
 C1² C2² 12+0⁵ F02 BASE = C1²

F0⁴ C0⁰ TO SUB BASE
 FQ¹⁵ F0¹⁵ TO SUB BASE
 F1³⁰ F0³⁰ TO SUB BASE
 C0³⁰

F0³ GRADE
 F1¹⁰ F0¹⁰ SUB BASE
 F2^{21.8} F1²⁰ SUB BASE
 F0¹ FINISH

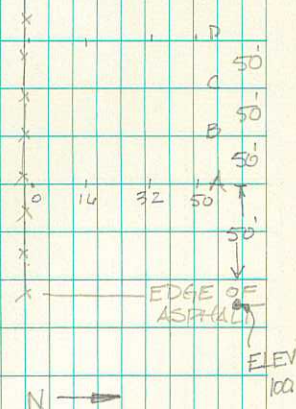

F1⁵ F0⁵ SUB BASE
 F2²² F0^{21.8} SUB BASE
 F2³⁵ F1¹⁵
 F1⁰

6⁴ 96⁷

6⁵ 96⁸

6⁶ 96⁹

103¹ 6⁶ 9796⁵

BM

3¹

100

17 JULY

SETTING CORNERS

HUDSON

FOR SHED AT CO. SHOP

WARD

CAME OFF FENCE 3' AND PARALLEL TO IT,
THEN OUT 36' RAN PARALLEL TO FENCE 137.33'

DIAGONALS MEASURED AS SHOWN

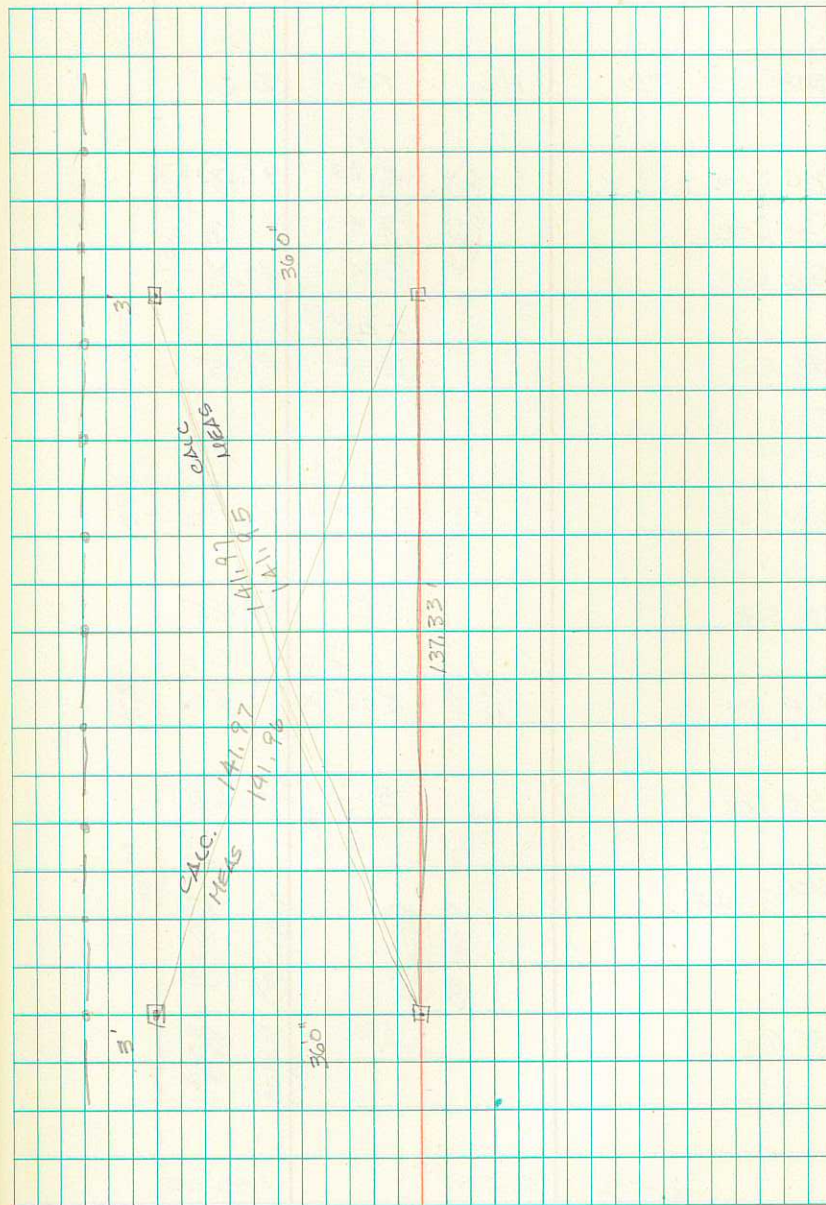

SETTING FINAL GRADE

STAT.	BS	HI	FS	ELEV
			5	
NW COR			5.85	97.00
SW COR			5.40	97.15
NE COR			5.55	97.00
SE COR			5.40	97.15
			5.55	
FINISH FLOOR ↑				
NW COR			6.05	96.50
SW COR			5.90	96.65
NE COR			6.05	96.50
SE COR			5.90	96.65
BASE GRADE				
SE COR			6.04	
	2.55	102.55		100.00

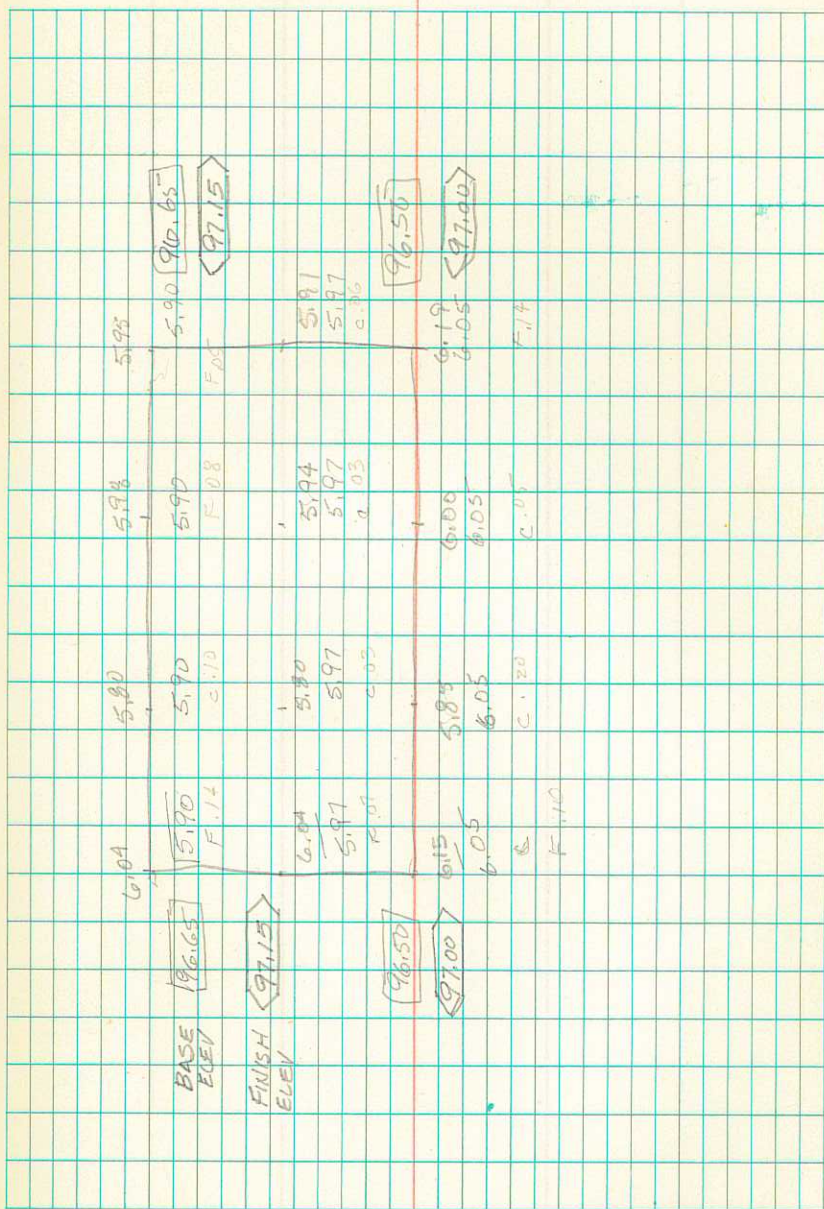

140 TON

120 #/CU FT

12 YDS = 324 CU ^{FT} YDS | LOAD

$$\begin{array}{r} 27 \\ 84 \\ 24 \\ \hline 324 \end{array}$$

10 LOADS = 3240 CU ^{FT} YDS

$$\begin{array}{r} 120 \\ 64800 \\ 32400 \\ \hline 388800 \\ 194.4 \text{ TON} \\ 2000 \overline{)388800} \end{array}$$

$\frac{2}{18}$

324

$$\begin{array}{r} 194.4 \\ 38.8 \\ \hline 155.6 \end{array}$$

2
648

120
12960
648

$$\begin{array}{r} 3888 \\ 2000 \overline{)38880} \end{array}$$

$\frac{16}{16}$
17

77760

CURVE AND REDUCTION TABLES

Published by Eugene Dietzgen Co.

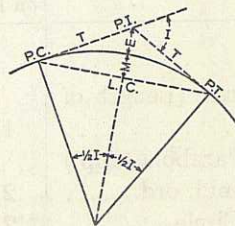

CURVE FORMULAS

1. Radius : $R = \frac{50}{\sin D/2}$
2. Degree of Curve: $D = 100 \frac{I}{L}$. Also, $\sin D/2 = \frac{50}{R}$
3. Tangent : $T = R \tan \frac{1}{2} I$. Also, $T = \frac{T \text{ for } 1^\circ \text{ curve}}{D} + C$.
4. Length of Curve: $L = 100 \frac{I}{D}$
5. Long Chord : $L.C. = 2R \sin \frac{1}{2} I$
6. Middle Ordinate: $M = R (1 - \cos \frac{1}{2} I)$
7. External : $E = \frac{R}{\cos \frac{1}{2} I} - R$. Also, $E = T \tan \frac{1}{4} I$.

EXPLANATION AND USE OF TABLES

Given P.I. Sta. 83+40.7, $I = 45^\circ 20'$ and $D = 6^\circ 30'$ find:

Stations—P.C. = P.I. - T. $T = \frac{T \text{ for } 1^\circ \text{ Curve}}{D} + C$. From Tables V and VI

$T = \frac{2392.8}{6.5} + 197 = 368.32 + 197 = 565.32$. Sta. P. C. = $83 + 40.7 - (3 + 68.32) = 79 + 72.38$.

P. T. = P. C. + L, and $L = 100 \frac{I}{D} = 100 \frac{45.33}{6.5} = 697.38$. Therefore, P. T. = $(79 + 72.38) + (6 + 97.38) = 86 + 69.76$.

Offsets—Tangent offsets vary (approximately) directly with D and with the square of the distance. From Table III Tangent Offset for 100 feet = 5.669 feet. Distance = 80 - Sta. P. C. = 27.62. Hence offset = $5.66 \times \left(\frac{27.62}{100}\right)^2 = .432$ ft. Also, square of any distance, divided by twice the radius equals (approximately) the distance from tangent to curve. Thus $(27.62)^2 \div (2 \times 881.95) = .432$ ft.

Deflections—Deflection angle = $\frac{1}{2} D$ for 100 ft., $\frac{1}{4} D$ for 50 ft., etc. For "X" ft., Deflection Angle (in minutes) = $.3 \times X \times D$. For Sta. 80 of above curve Deflection Angle = $.3 \times 27.62 \times 6.5 = 53.86'$. Also Deflection Angle = defl. for 1 ft. from Table III $\times X = 1.95 \times 27.62 = 53.86'$. For Sta. 181 Deflection Angle = $53.86' + \frac{6^\circ 30'}{2} = 4^\circ 8.86'$.

Externals—From Table V for 1° curve, with central angle of $45^\circ 20'$, $E = 479.6$. Therefore, for $6^\circ 30'$ curve, $E = \frac{479.6}{6.5} + \text{Correction from Table VI} = 7.378 + .039 = 7.417$.

$$\begin{array}{r} 4 \text{ } 3 \\ 105 \text{ } 5 \\ \underline{7 \text{ } 8} \\ 98 \text{ } 2 \end{array}$$

$$\begin{array}{r} 4 \text{ } 3 \\ 105 \text{ } 5 \\ \underline{9 \text{ } 8} \\ 95 \end{array}$$

$$\begin{array}{r} 105 \text{ } 3 \\ \underline{97 \text{ } 0} \\ 8 \text{ } 3 \\ - 1 \text{ } 4 \\ \hline 9 \text{ } 3 \end{array}$$

$$\begin{array}{r} 14 \text{ } 2 \\ 105 \text{ } 4 \\ \underline{9 \text{ } 4} \\ 1052 \end{array}$$

$$\begin{array}{r} 102 \text{ } 1 \\ \underline{103 \text{ } 5} \\ 96 \text{ } 5 \\ \hline 6 \end{array}$$

$$\begin{array}{r} 103 \text{ } 1 \\ \underline{6 \text{ } 8} \\ 96 \end{array}$$

$$\begin{array}{r} 5 \text{ } 3 \\ 96 \text{ } 5 \\ \underline{6 \text{ } 8} \\ 102 \text{ } 1 \\ \underline{103 \text{ } 5} \\ 96 \end{array}$$